

pananditeivi mõõt

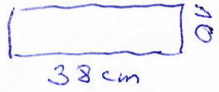

lisaks 2 posti $3,9 \text{ m}^2$
 1 post 4 milge $\times 20 \text{ cm}$; $h = 243 \text{ cm}$

kokku = $7,3 \text{ m}^2$
 $3,9 \text{ m}^2 = 11,21$
 $25,5 \text{ m}^2 = 36,7$

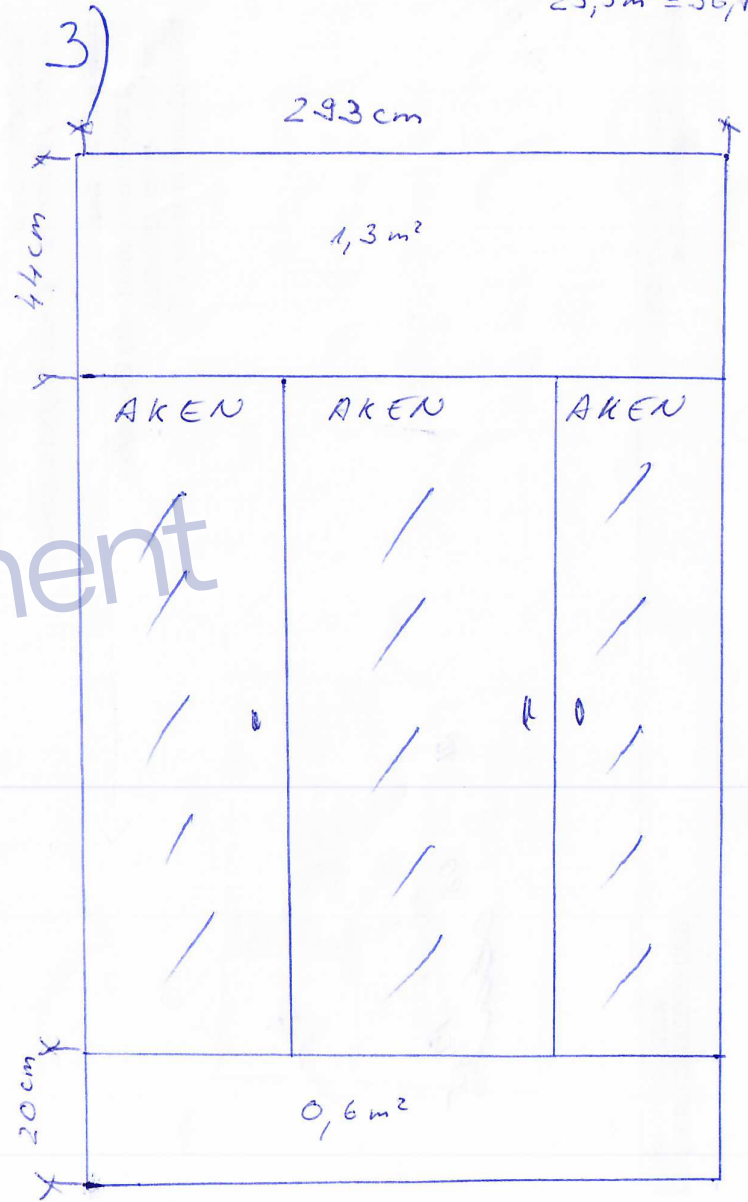
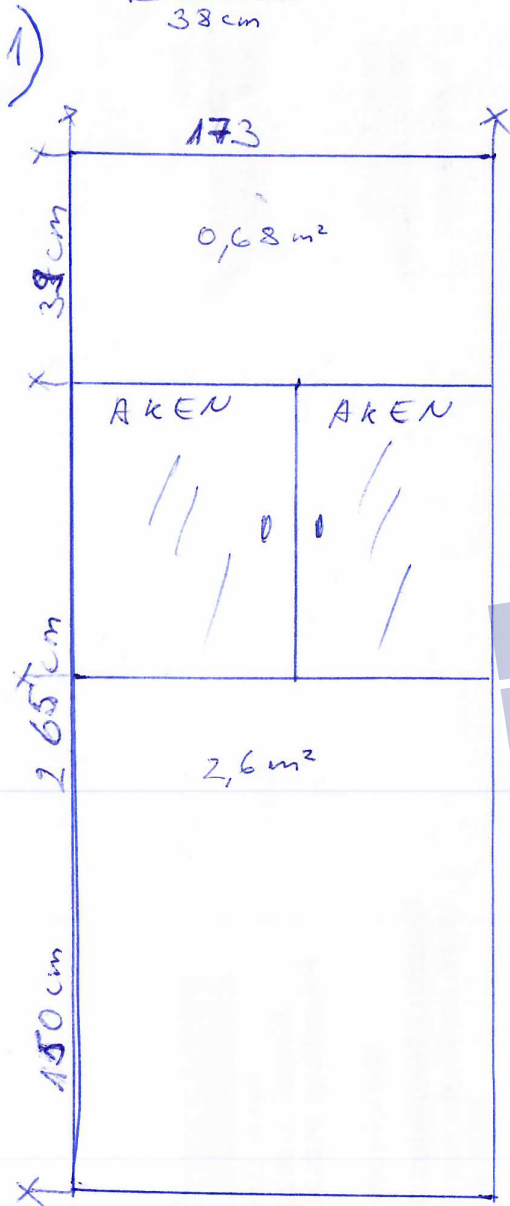

pdfelement