

Torni laetlastiku skeem

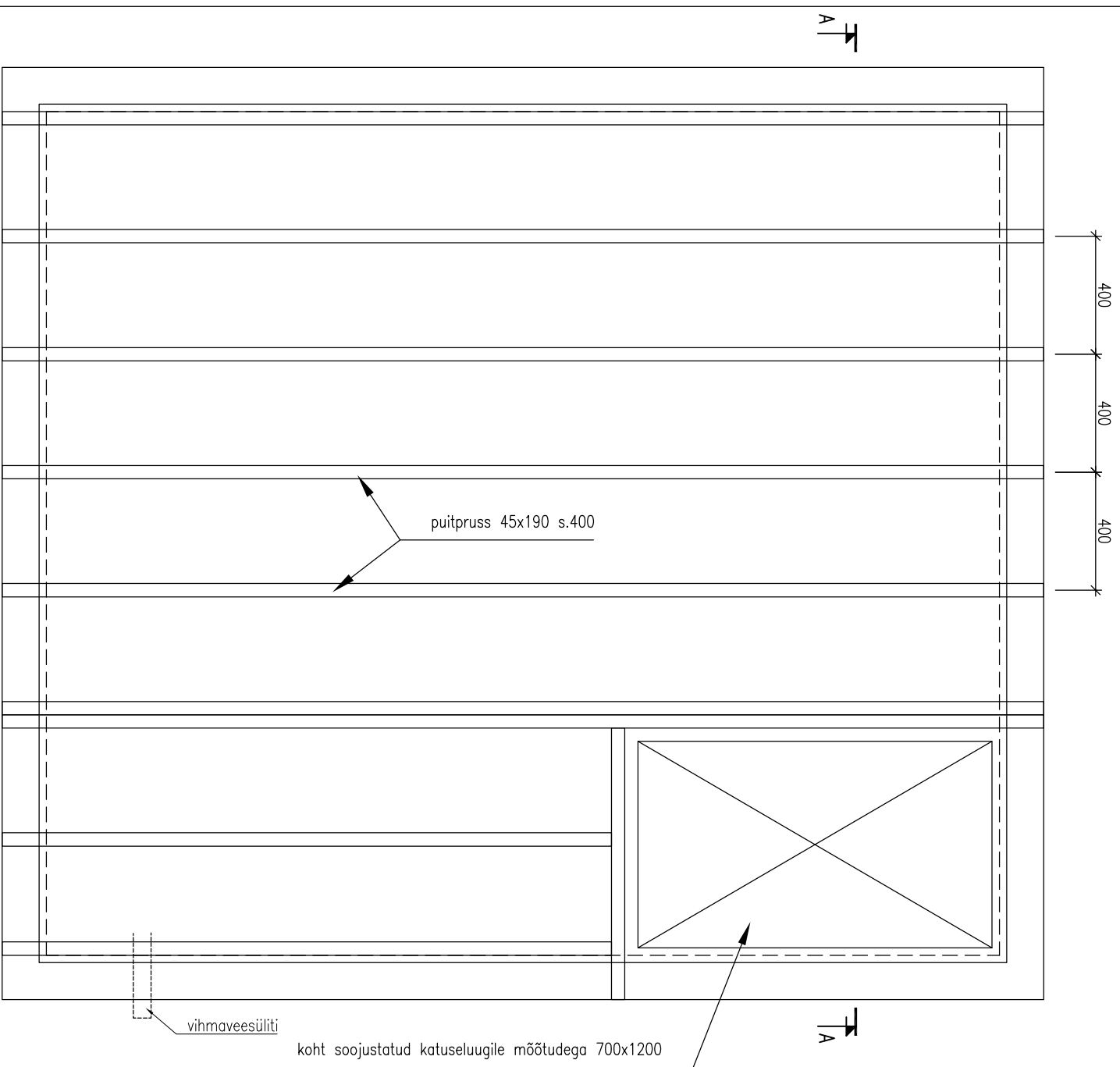

A - A

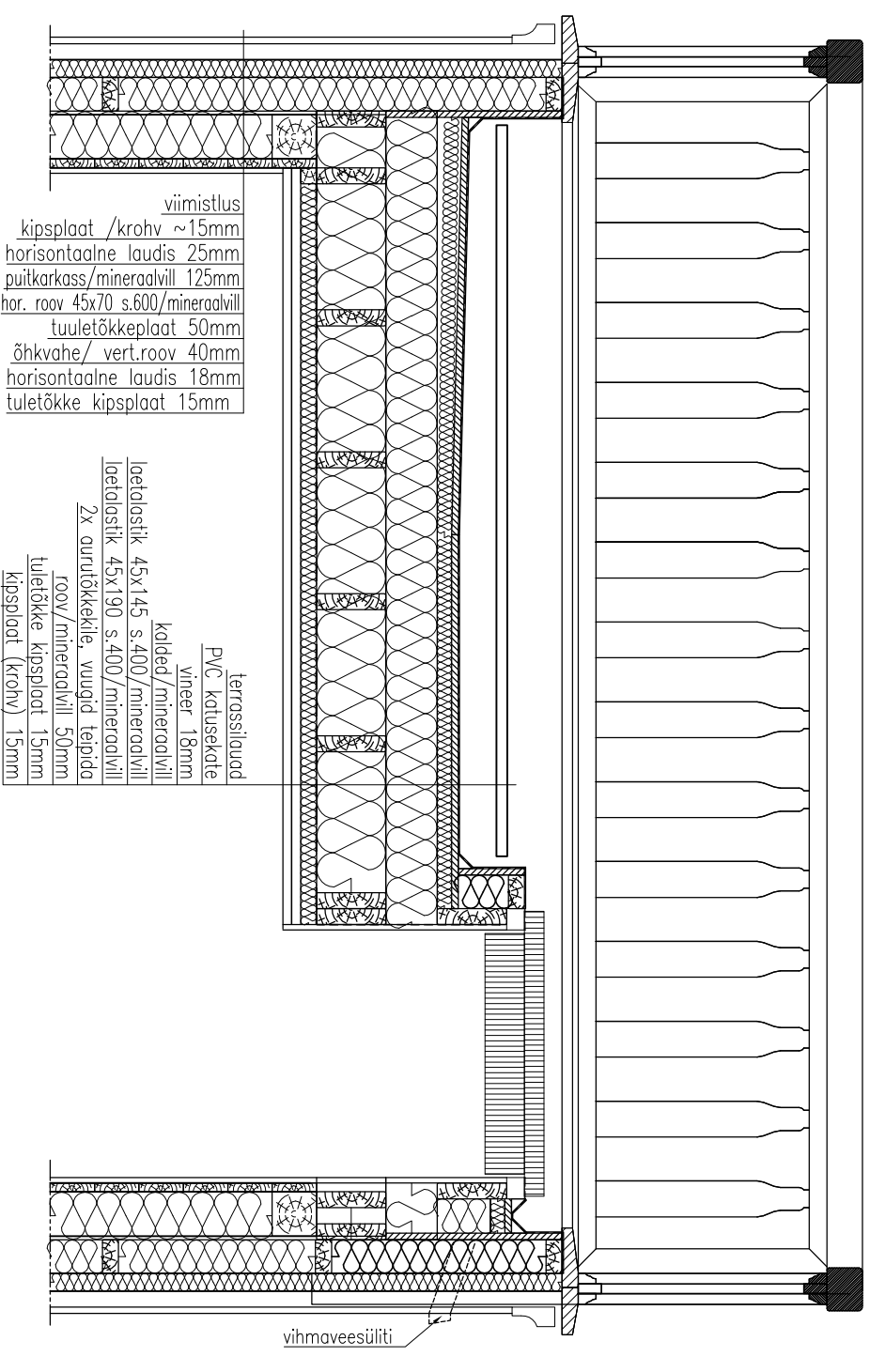

MÄRKUSED:

- Üldise karkassivahelise soojustusena kasutada puiste kivivilla ($\lambda_d \leq 0,041$ W/mK);
- Tuletõkkeplaadina kasutada 50mm kivivilliplaati nt. Parroc Cortex ($\lambda_d \leq 0,033$ W/mK);