

CULTURA

Drawings 170426

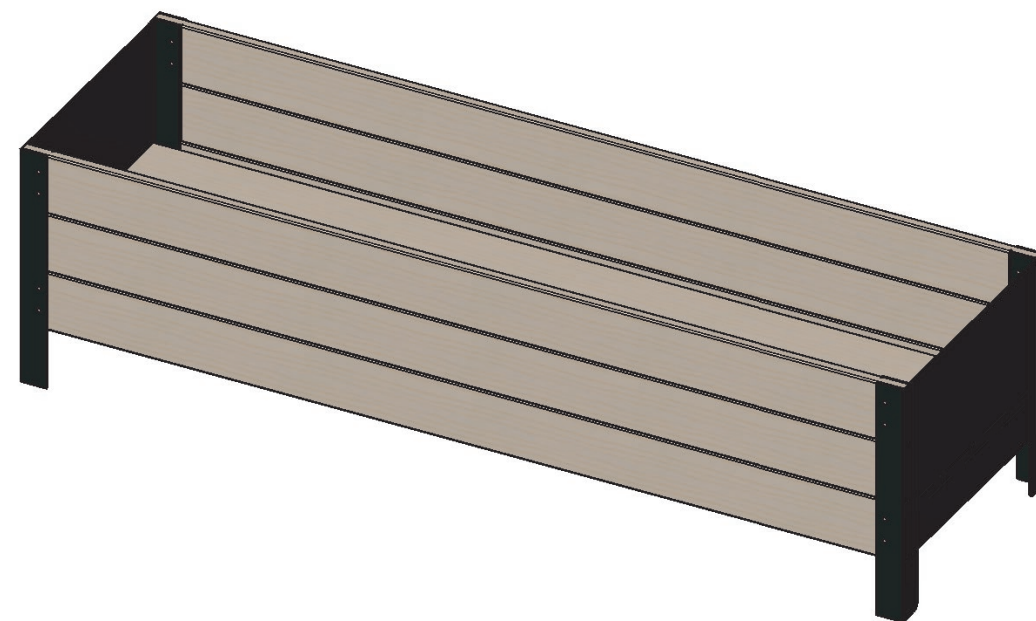
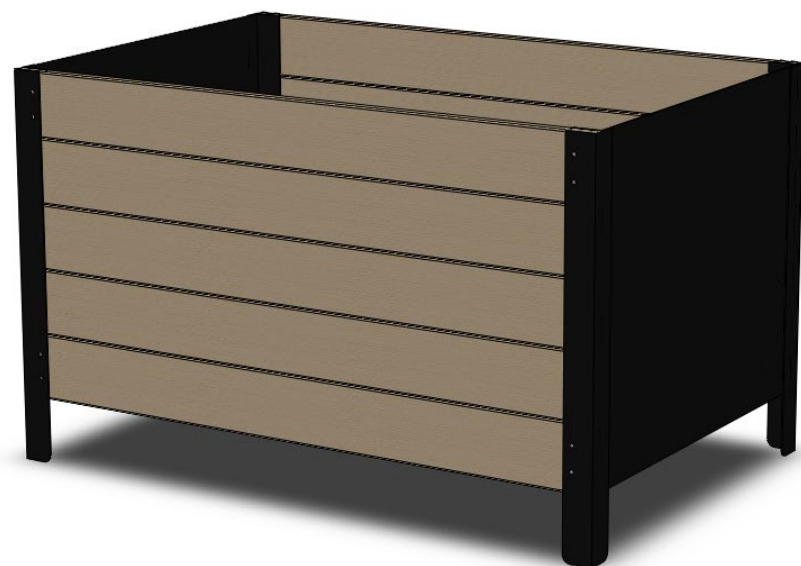

CULTURA

General Assembly

Exploded view
Assembly

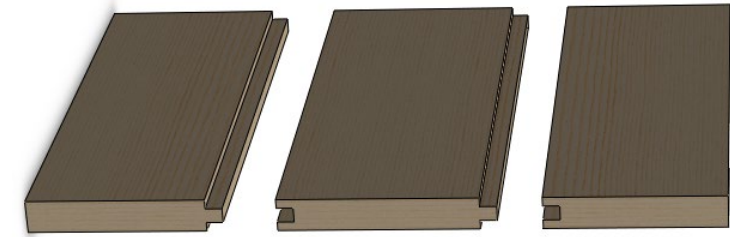

Bottom joints

Crossbeams help carry
the weight of the soil.

2. The pre-assembled floor is put into
place from the top.

There is a guide in the sides
and a slot in the planks to
give strenght and allign the
components.

1. The planks for the front and
back slides into the slots from underneath
and are then attached. One of them have
a support beam to carry the floor. The
customer can chose where to place this
plank and thereby vary the height.
Fastend with screws.

Sideboards joints

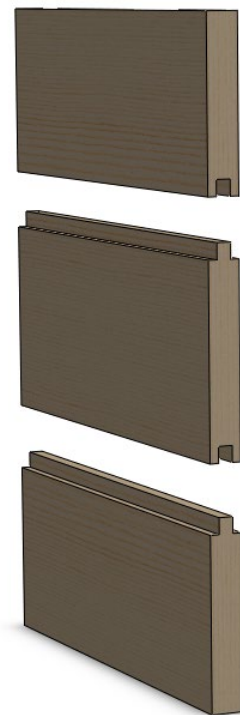

CULTURA

Medium planter

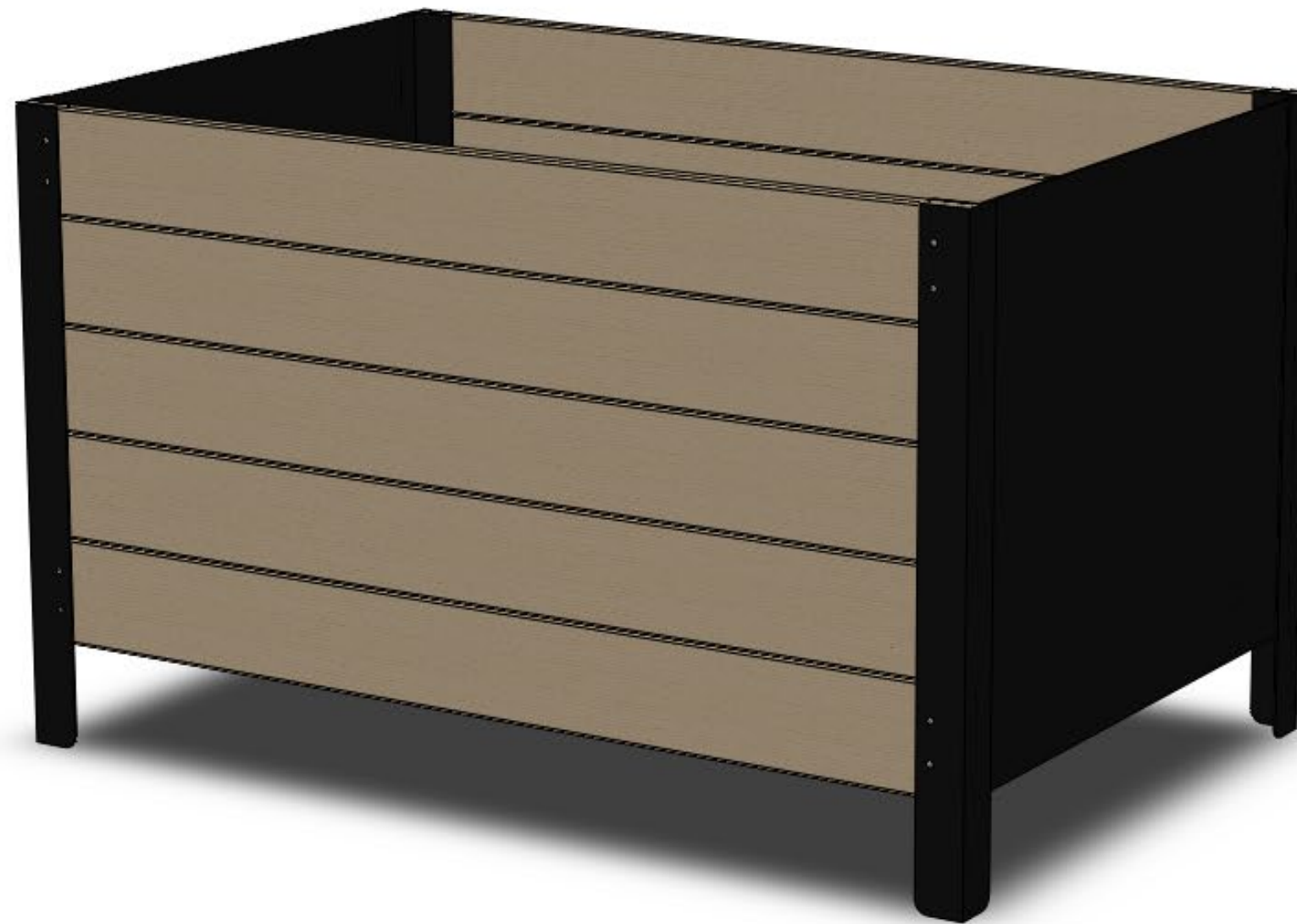

CULTURA

Drawings 170426

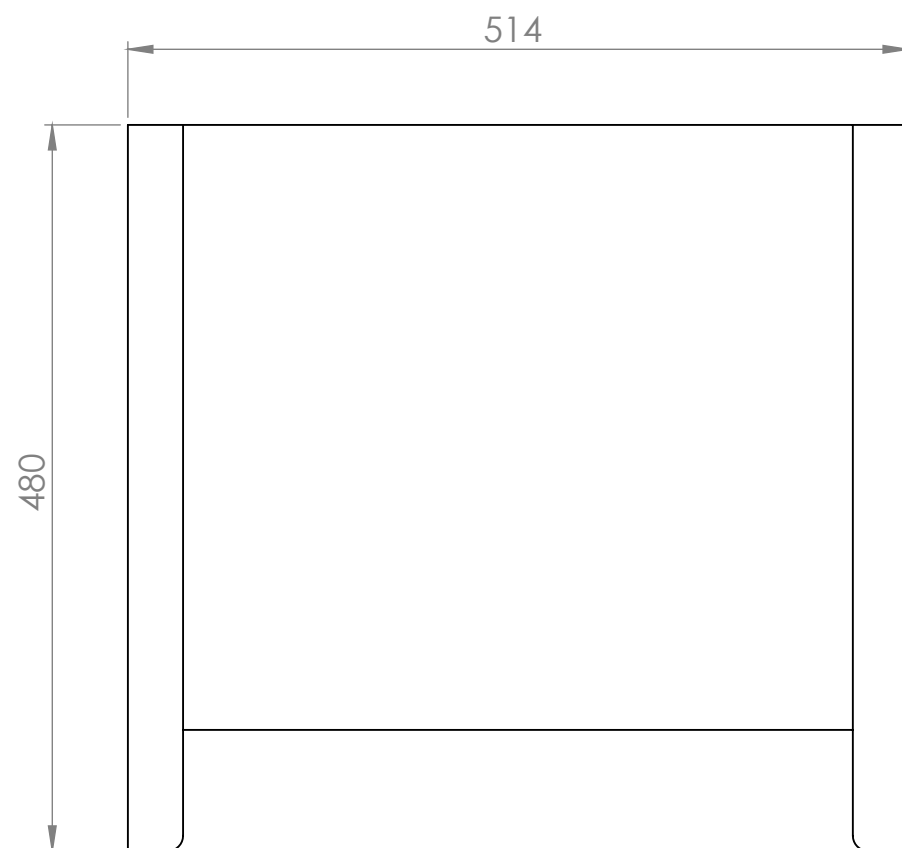
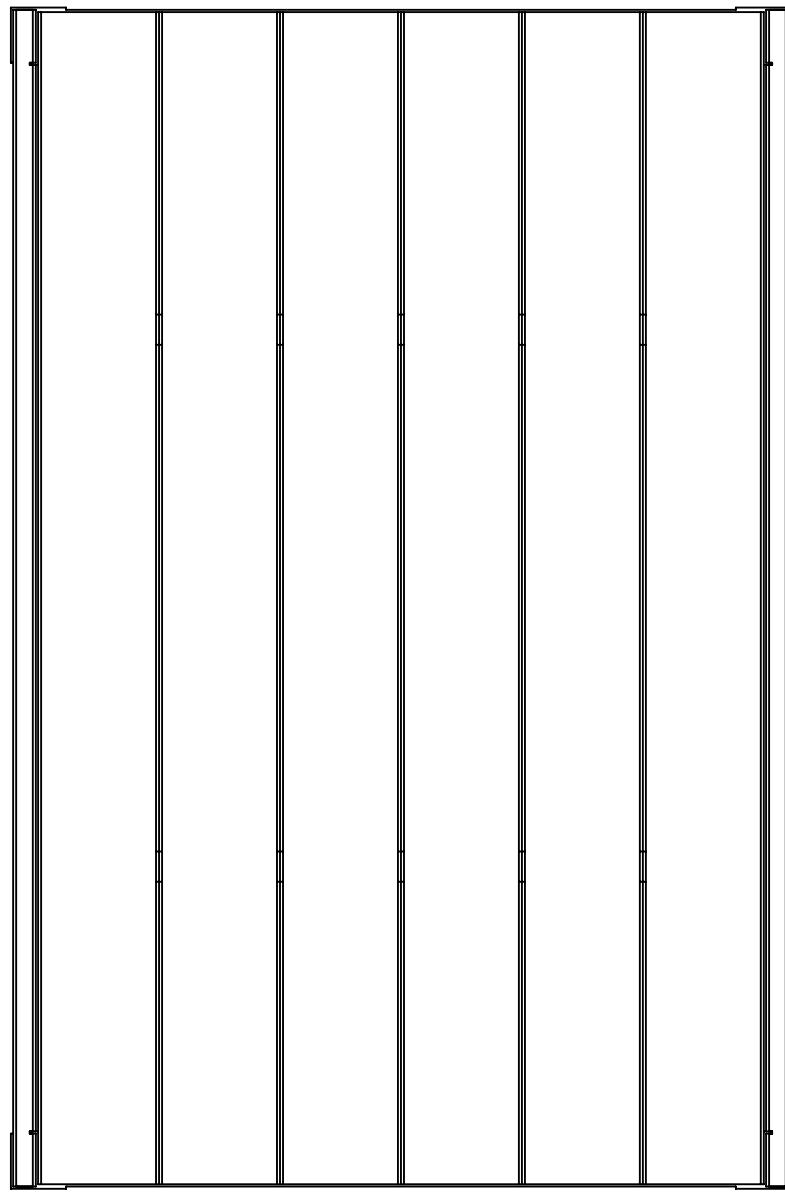

Plank dimensions

The same plank is used for the floor and the sides.
Use suitable standard dimension from supplier when possible.
Adjust metal components if size change.

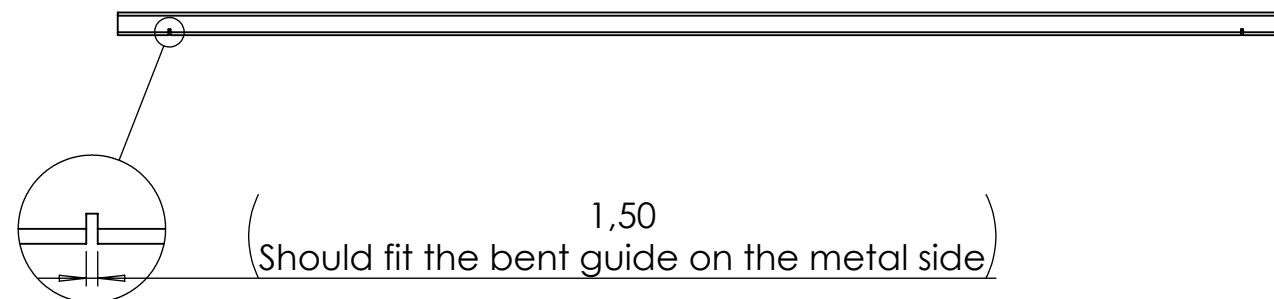
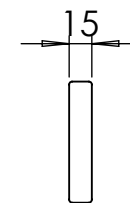
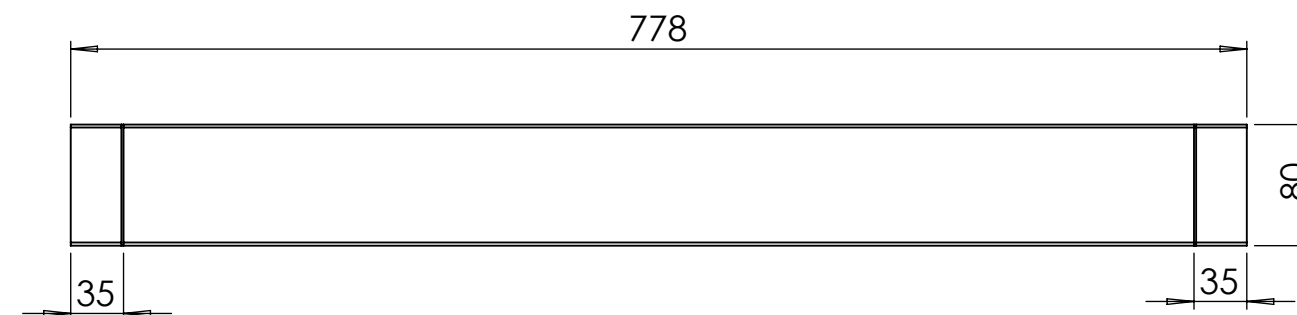

CULTURA

Drawings 170426

Side component
dimensions

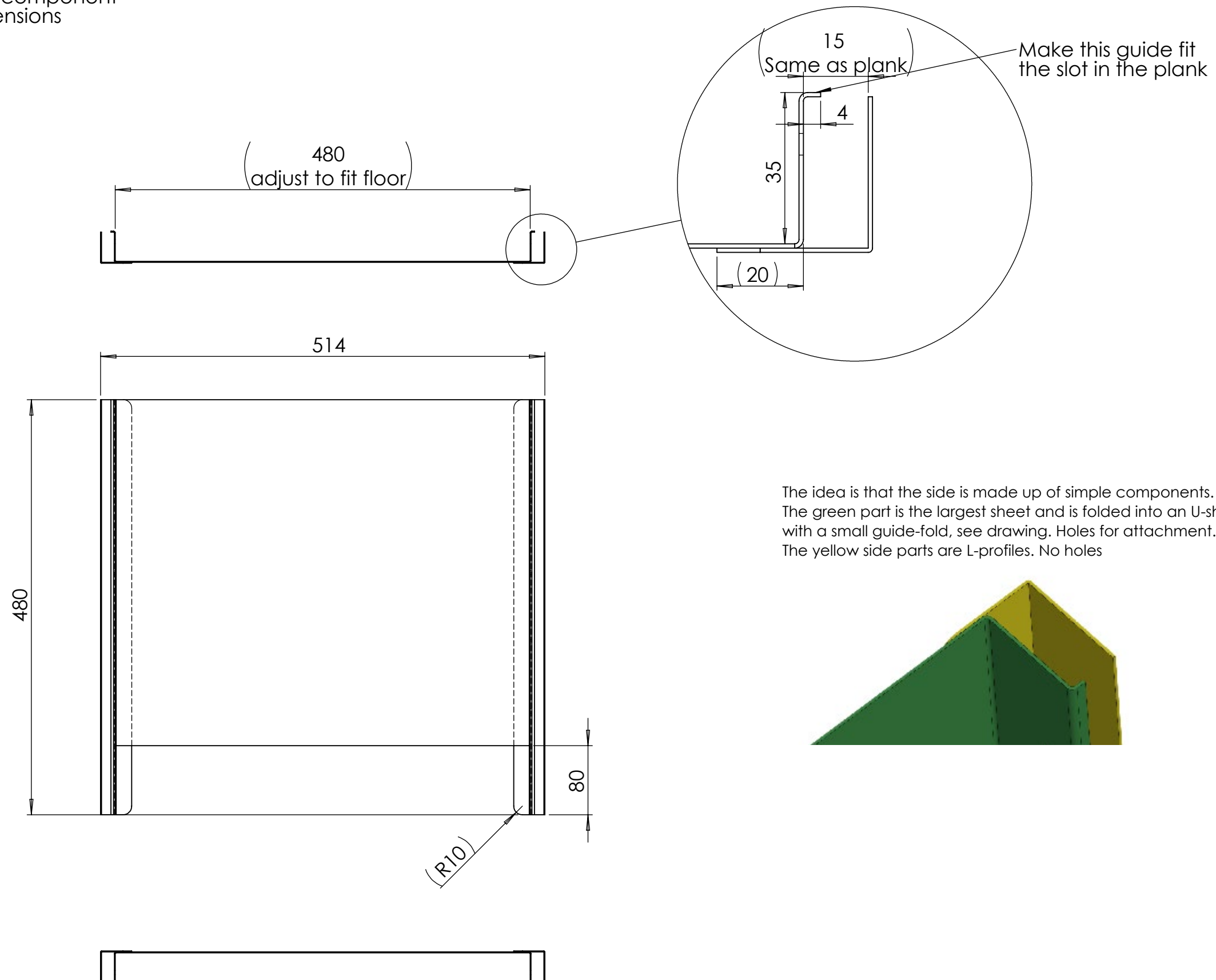

CULTURA

Drawings 170426

Bottom

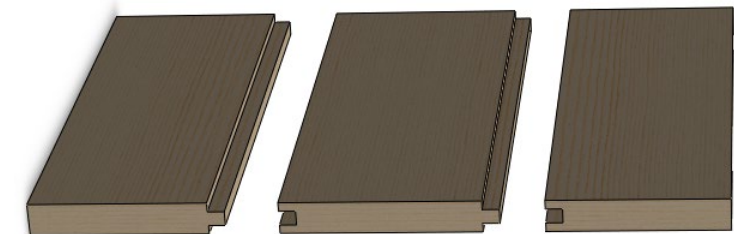
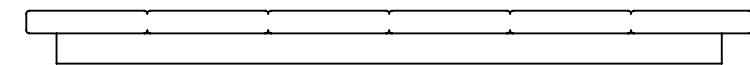
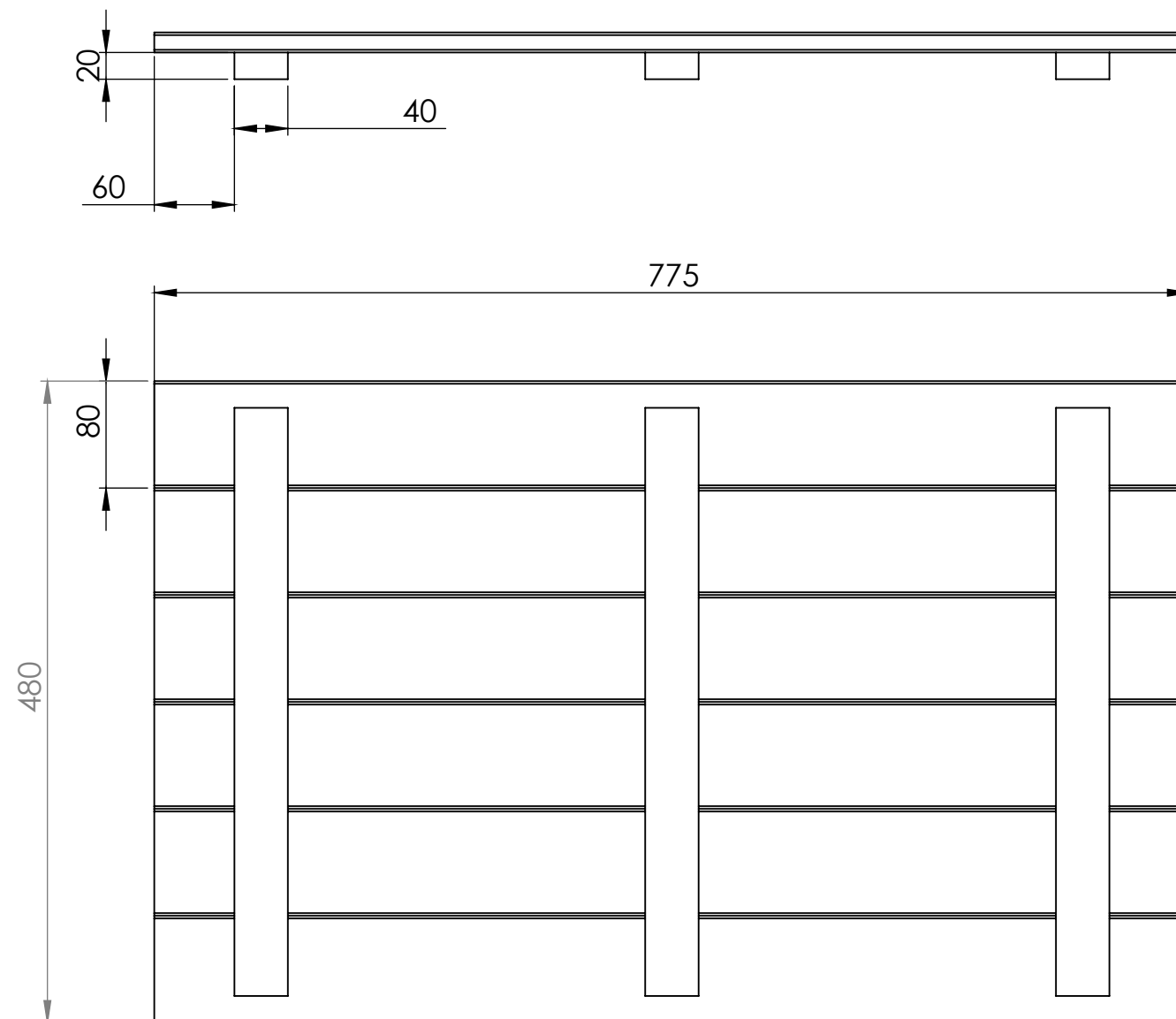

Bottom joints

CULTURA

Raised planter



CULTURA

Drawings 170426

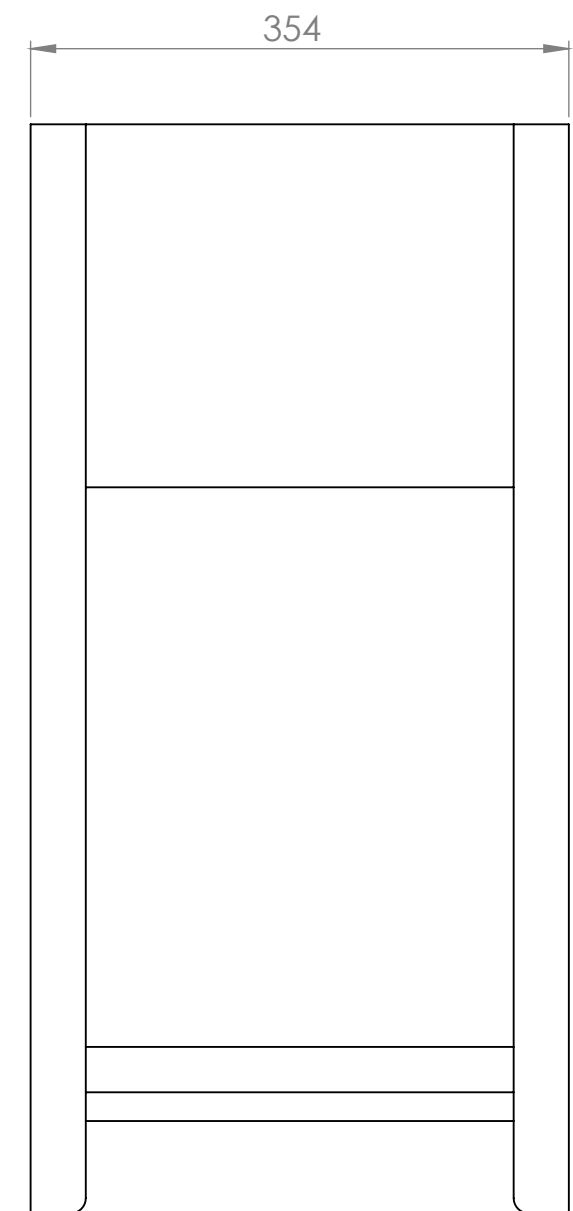
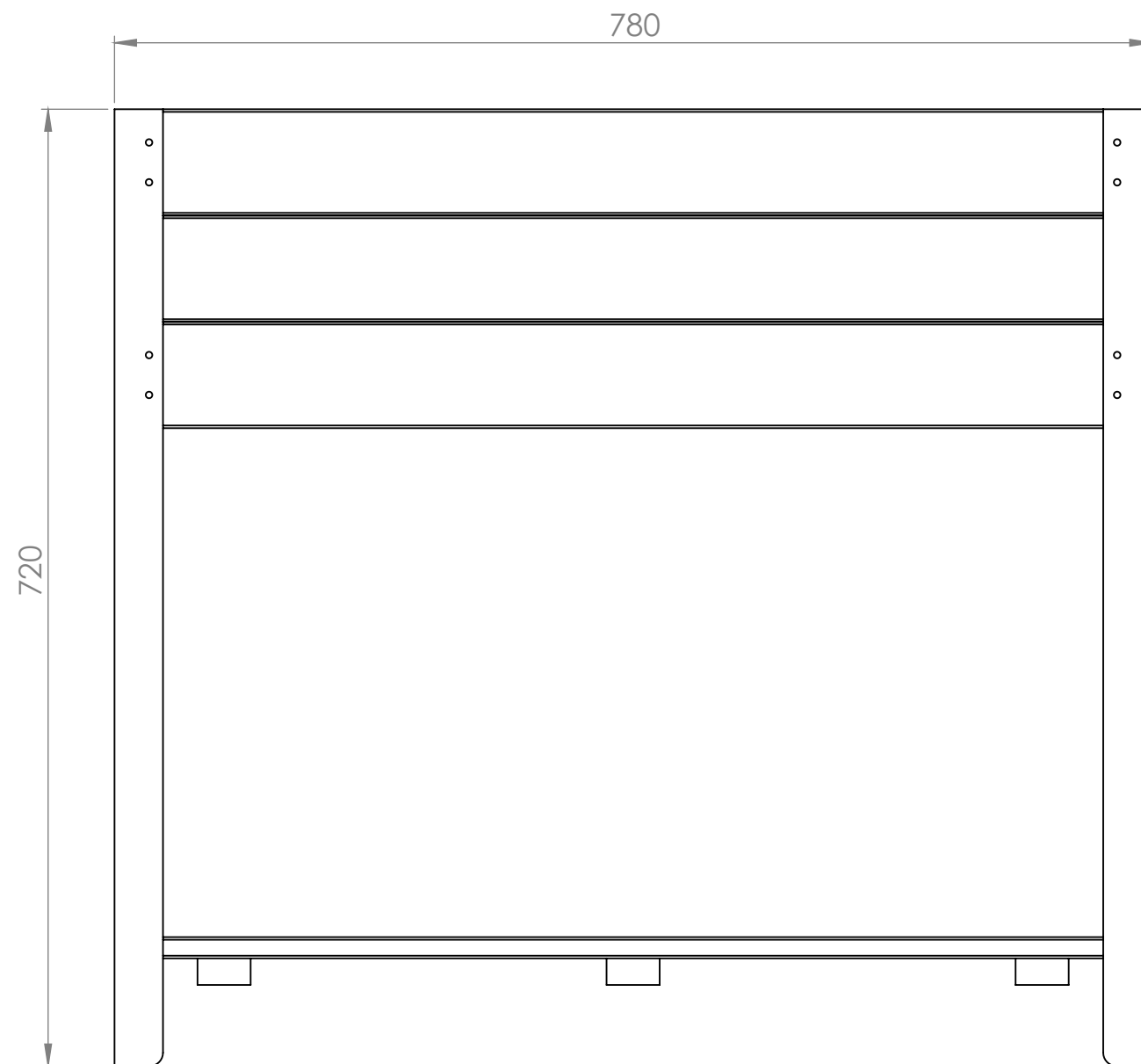
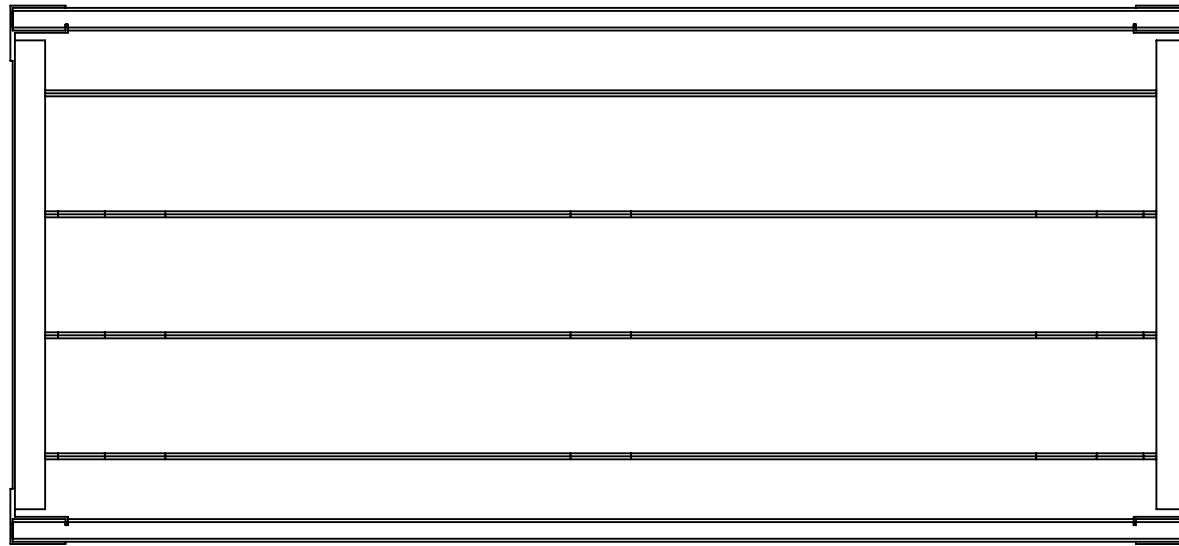

Side component
dimensions

CULTURA

Drawings 170426

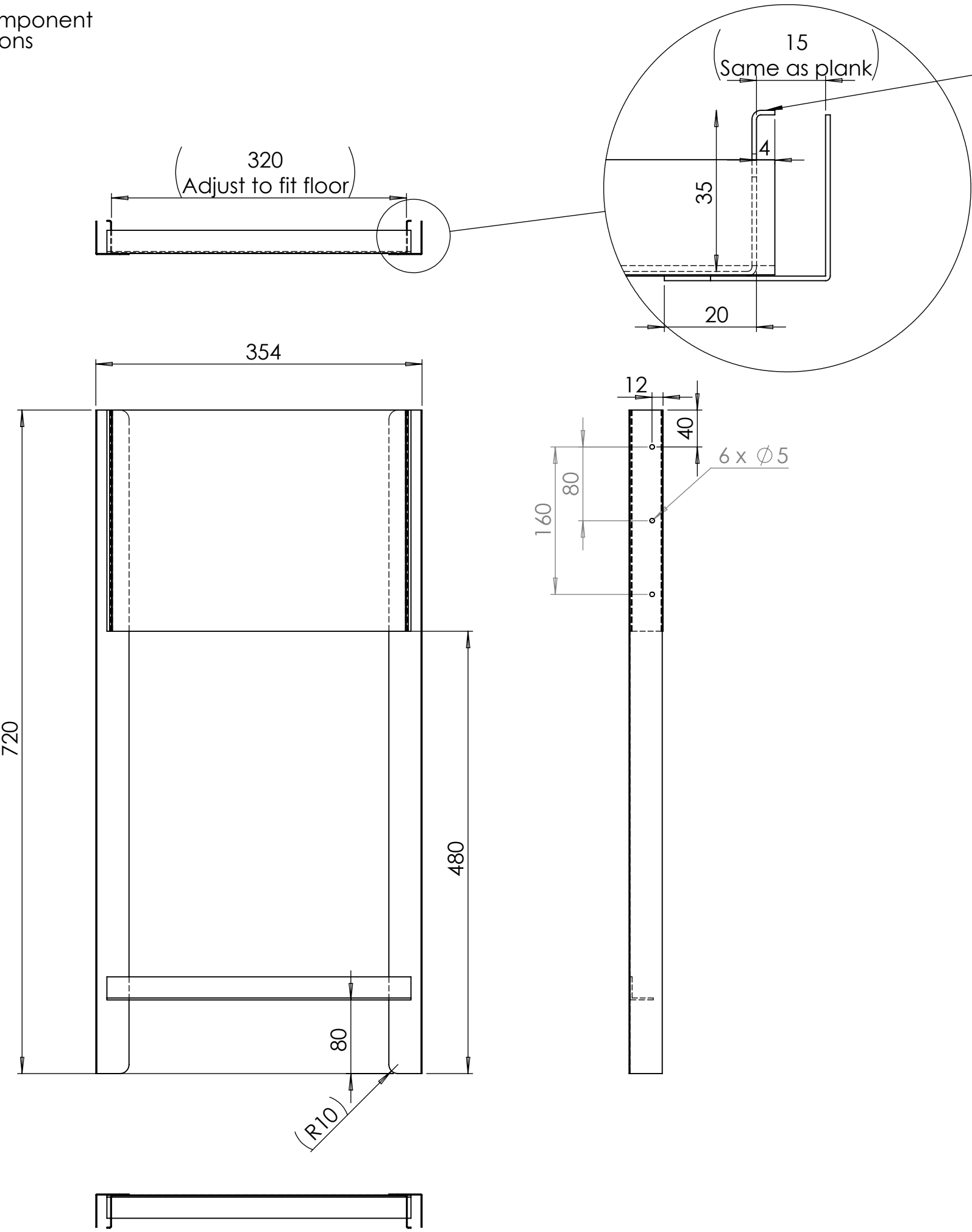

The idea is that the side is made up of simple components.
The green part is the largest sheet and is folded into an U-shape
with a small guide-fold, see drawing. Holes for attachment.
The yellow side parts are L-profiles. No holes

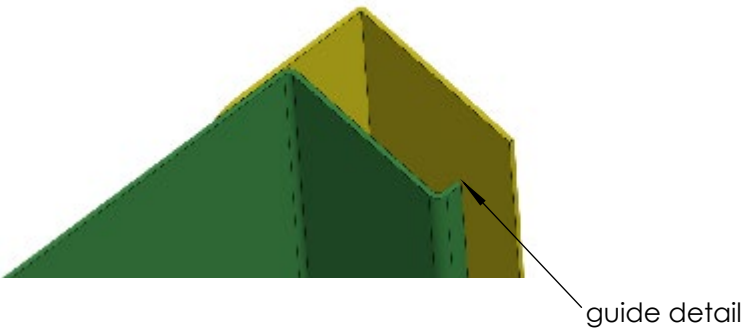

Plank dimensions

The same plank is used for the floor and the sides.
Use suitable standard dimension from supplier when possible.
Adjust metal components if size change.

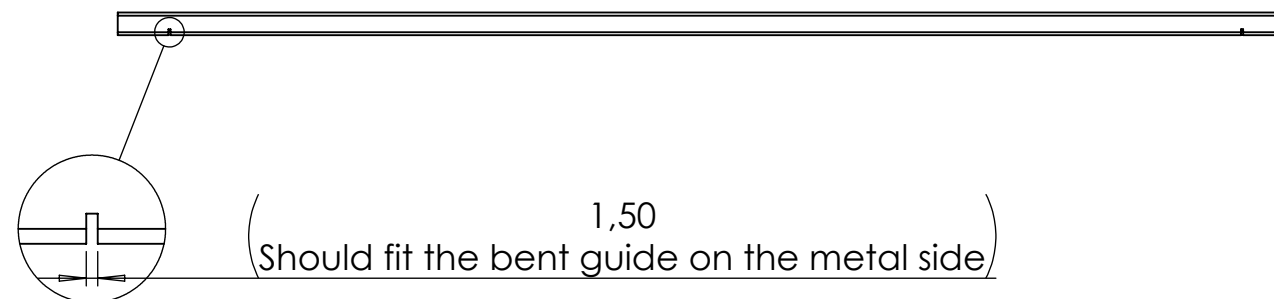
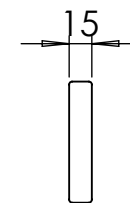
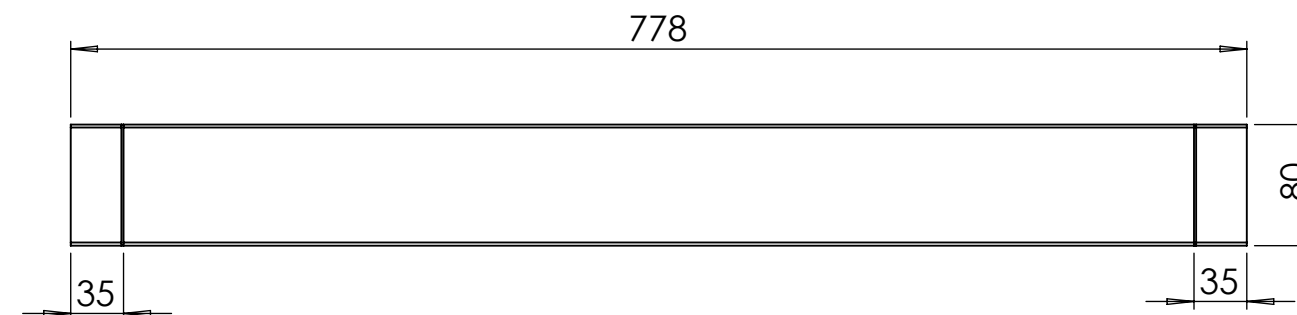

CULTURA

Drawings 170426

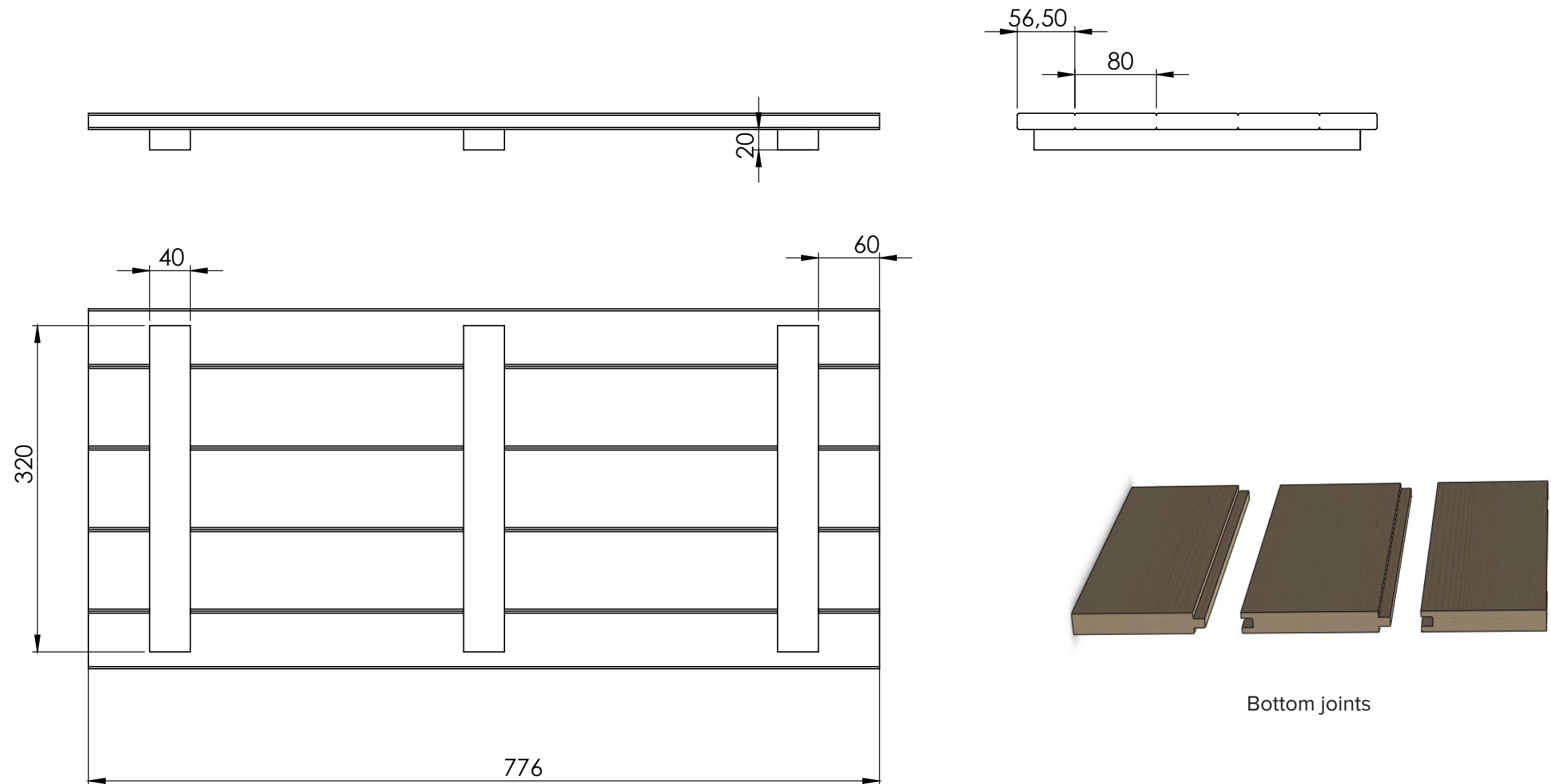

CULTURA
Long planter

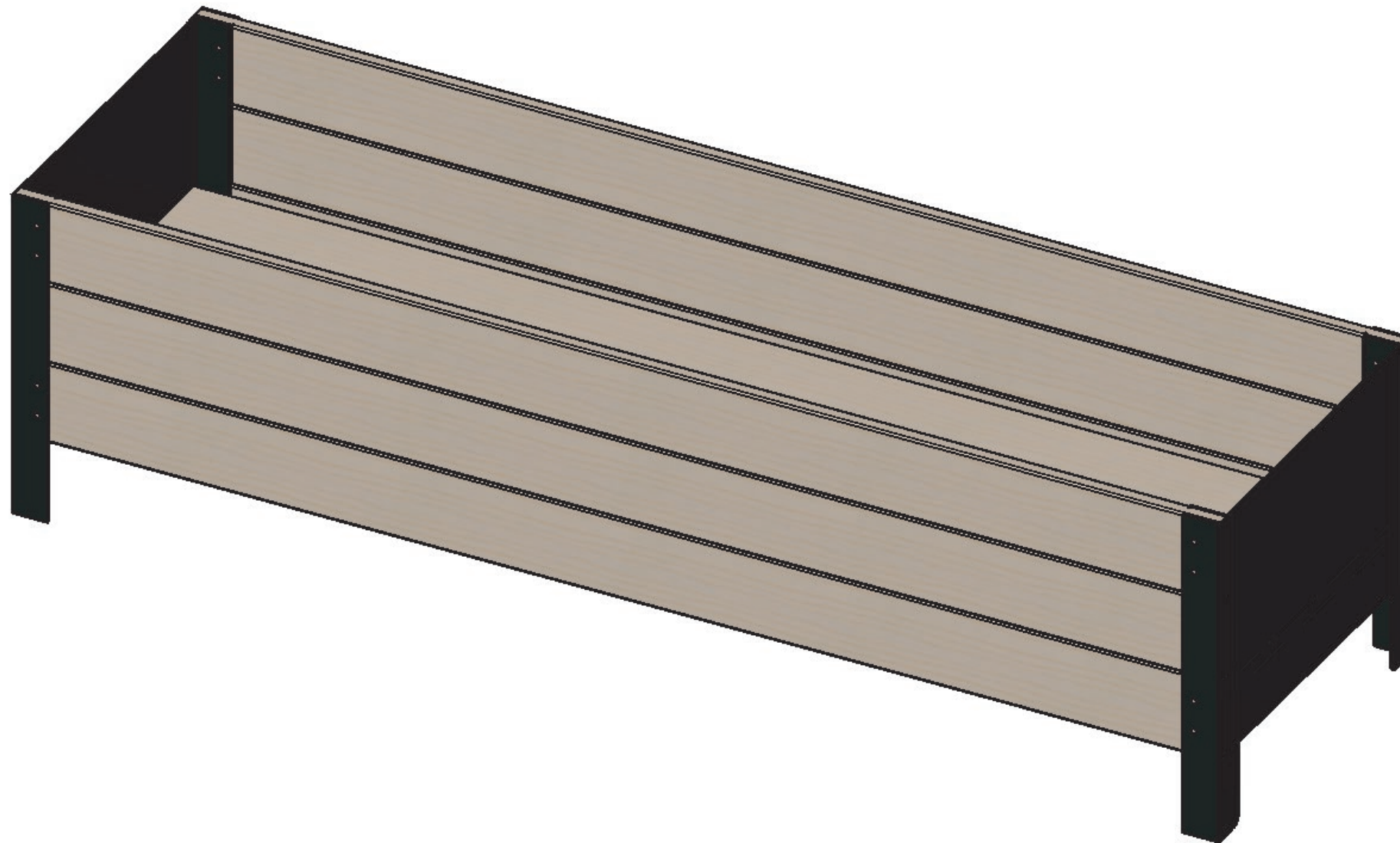

CULTURA

Drawings 170426

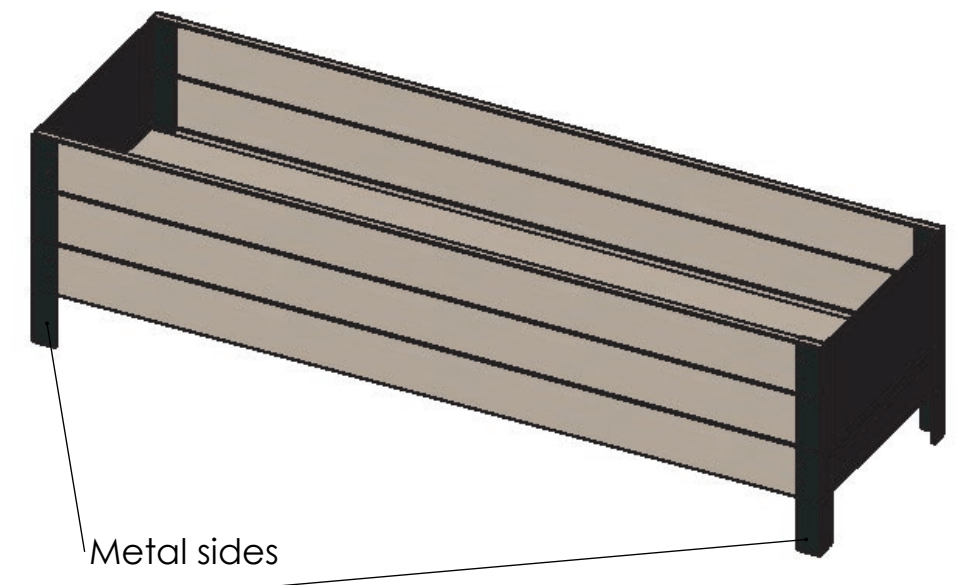
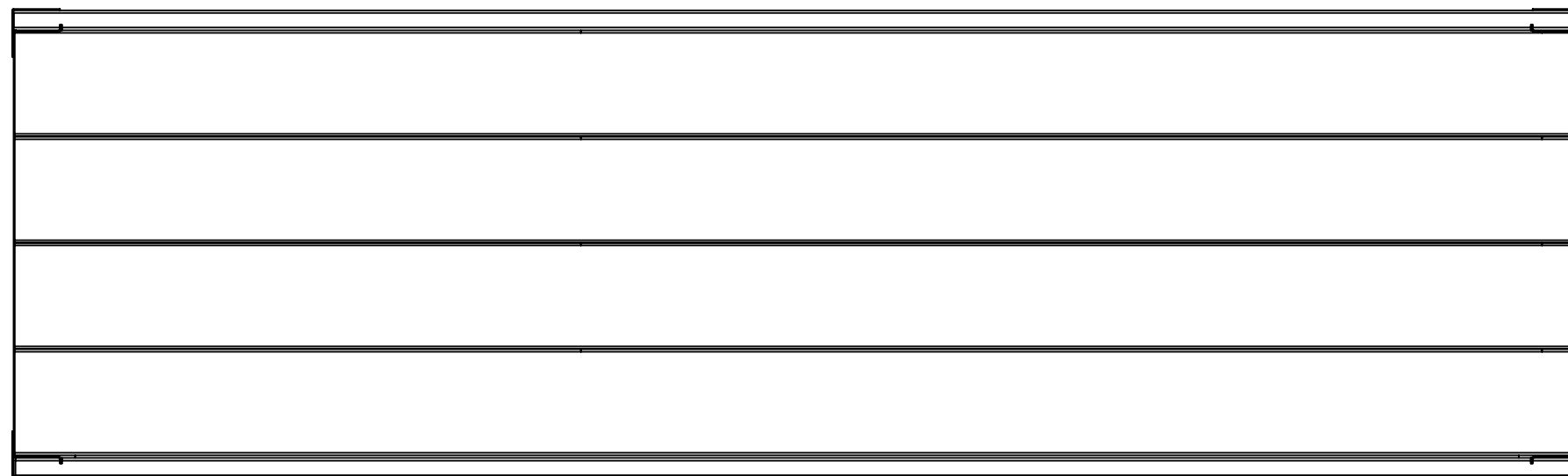
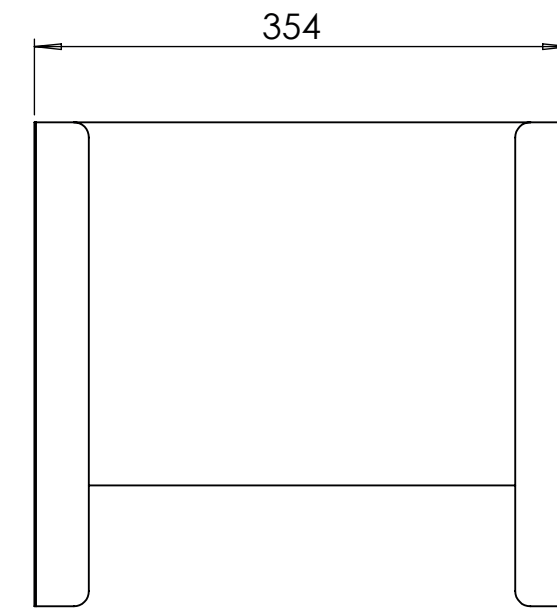
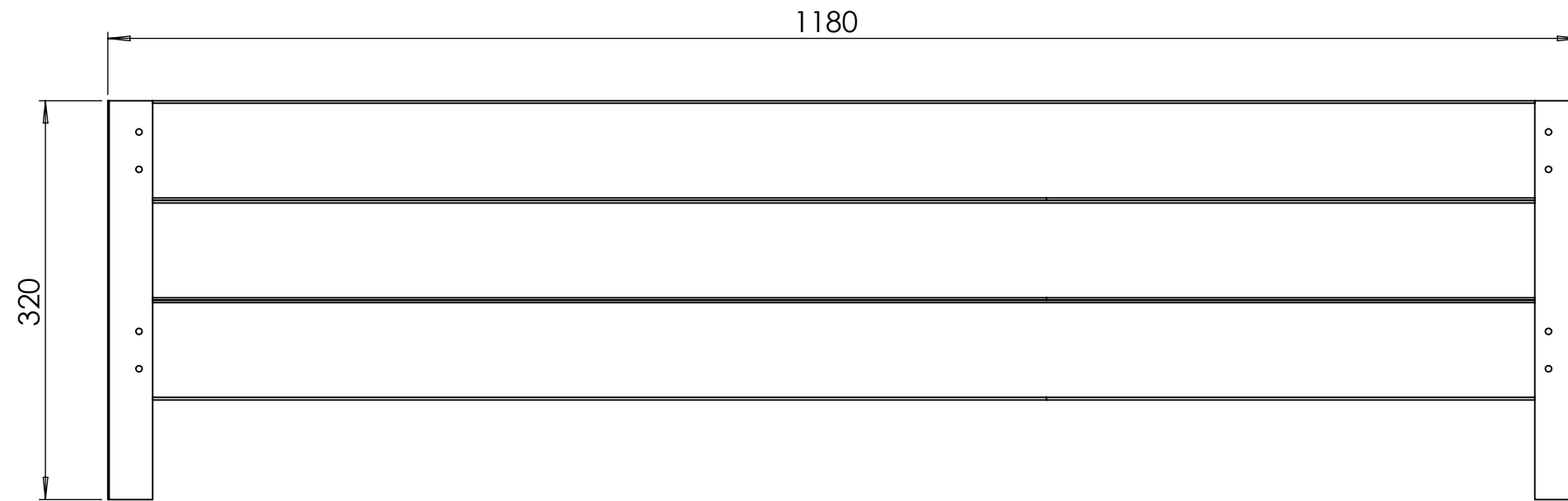

Note: adjust dimensions to fit previous models of TILIA range

Plank dimensions

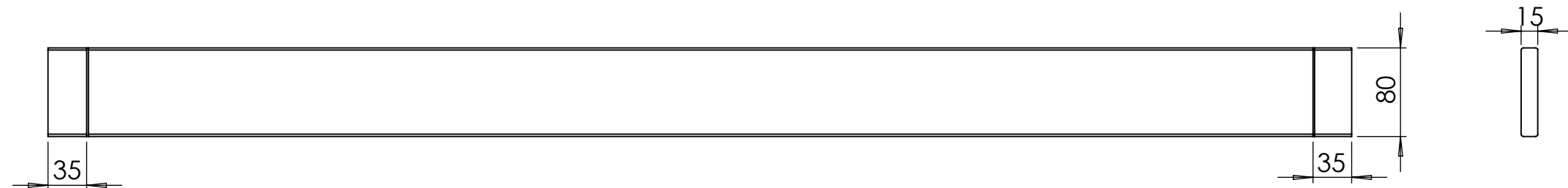

The same plank is used for the floor and the sides.
Use suitable standard dimension from supplier when possible.
Adjust metal components if size change.

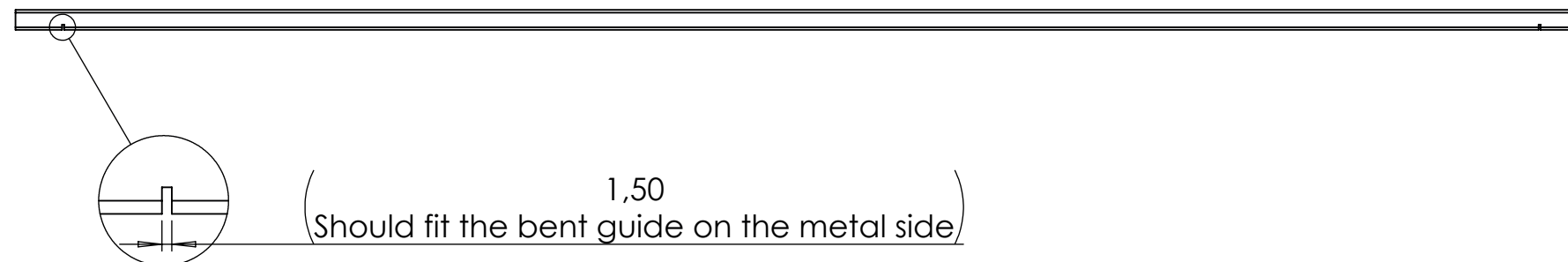

Side component
dimensions

CULTURA

Drawings 170426

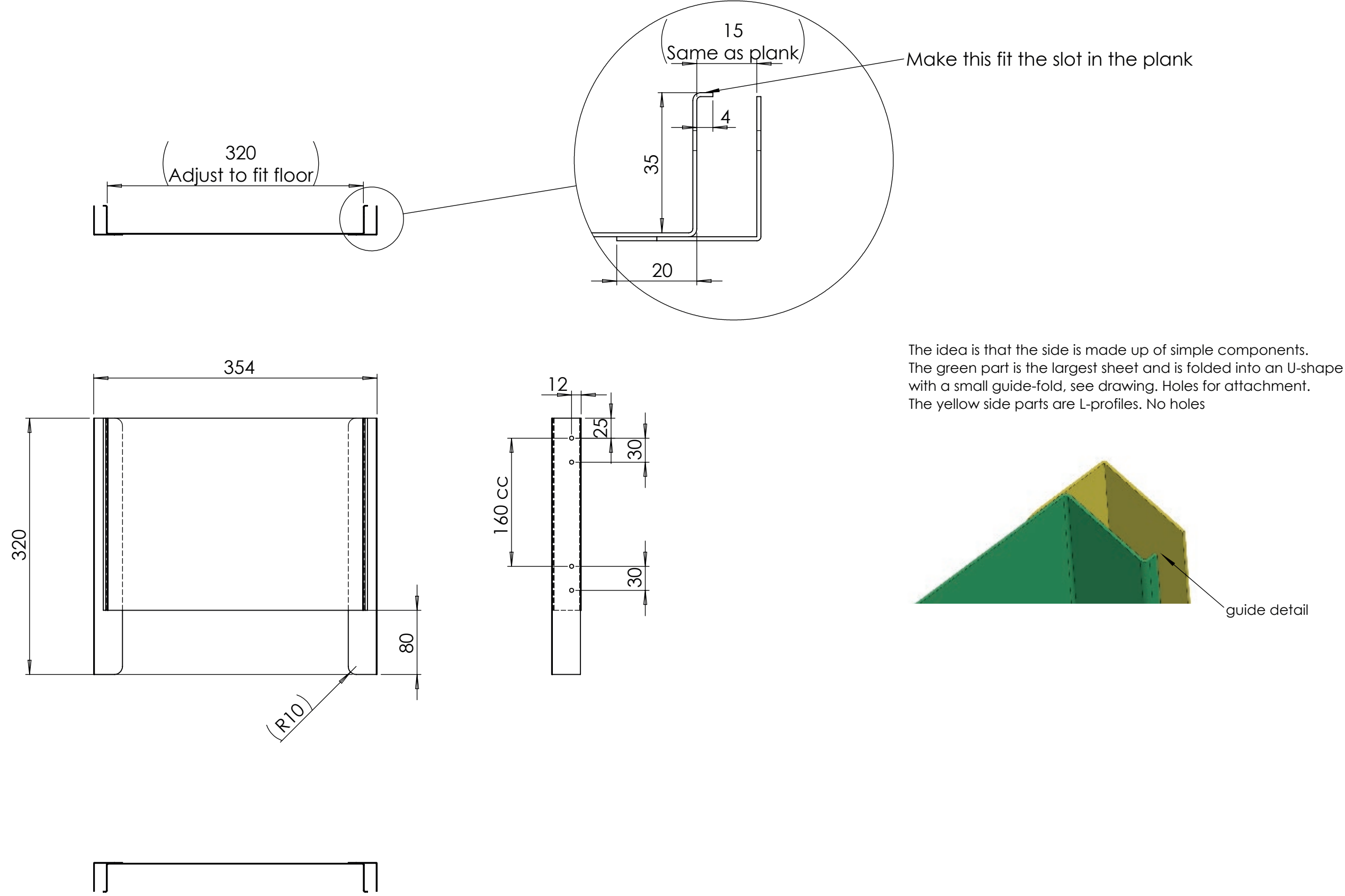

CULTURA

Drawings 170426

Bottom

NOTE: use same construction as the large
TILIA planter box for this component

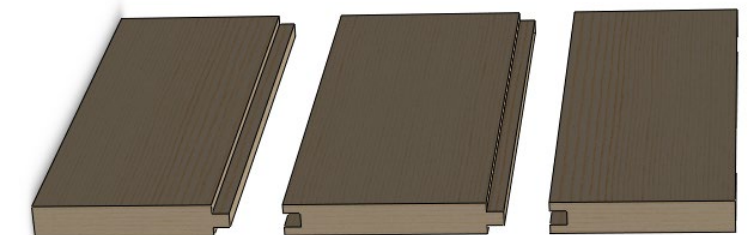
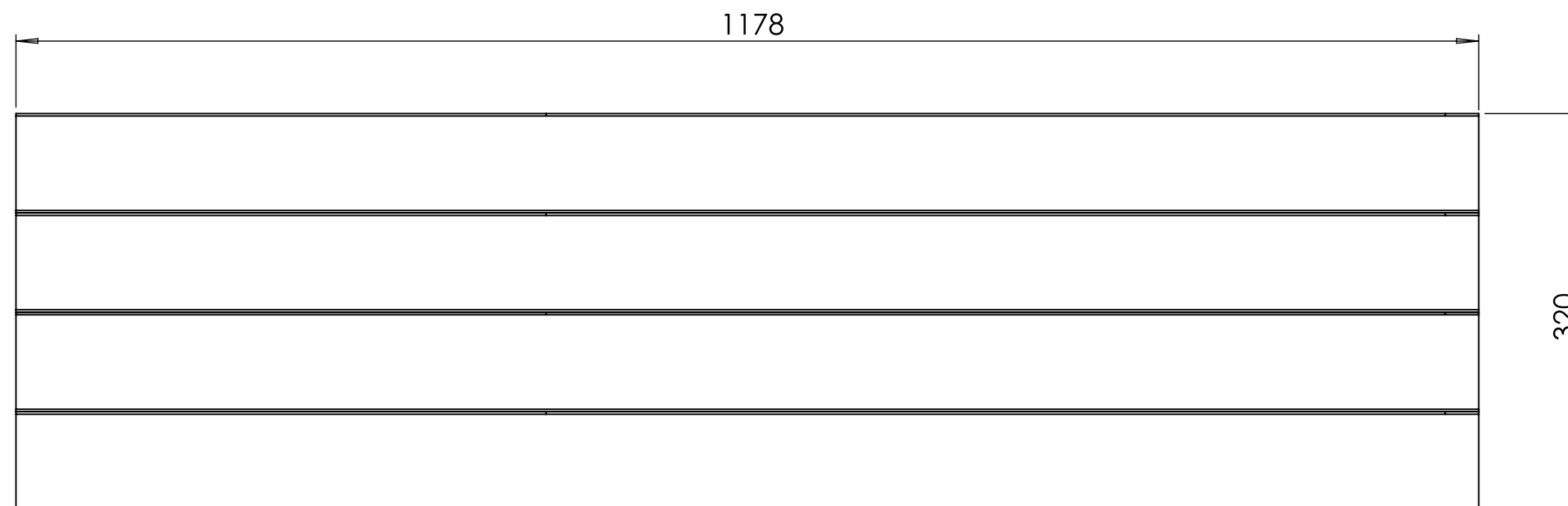
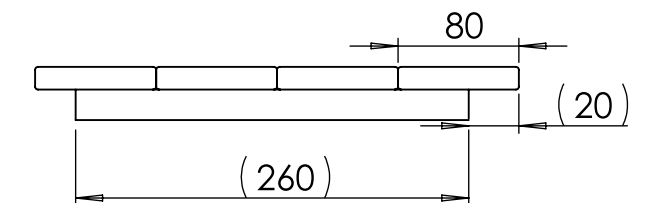
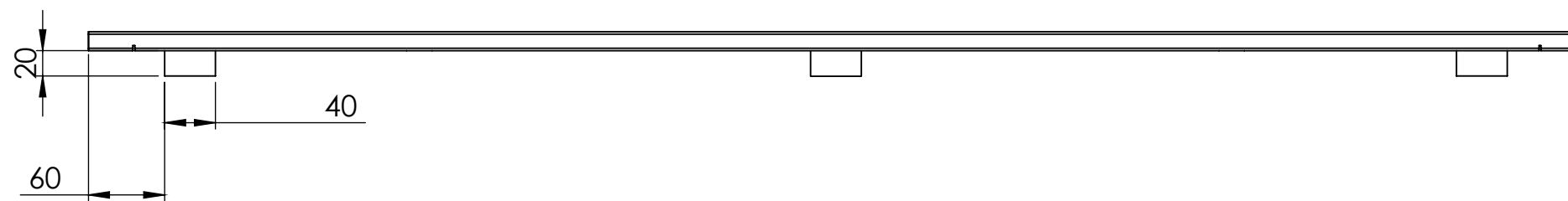

Bottom joints